

E-SERIES POE NVR RECORDER

OE-ENVRPOE4

OE-ENVRPOE8

OE-ENVR16



DESCRIPTION

The newest addition to the E-Series embedded recorder lineup, E-Series NVR, merges powerful high definition network video recording with the ease of Plug N' Play installation. Housed in a compact chassis, the E-Series NVR supports OpenEye Power over Ethernet (PoE) cameras that enable fast and easy access to recording resolutions up to 1080p.

Multiple remote users can view, search, and back up data for off-site storage as well as configure the recorder using RADIUS video management software.

Active health monitor Heartbeat will check E-Series NVR's connectivity to cloud-based health monitor ReportStar every five minutes, decreasing your system disconnect down time to mere hours. Additional features include eSATA output to additional video storage devices, and free DDNS for the life of the product. Get mobile access through MDVR, the same high quality mobile app used by other OpenEye recorders, available on iTunes and Google Play.

Built with the same quality and expertise users have come to expect from OpenEye, the E-Series NVR is ready to supply fast Plug N' Play high definition video at your next installation.

HIGHLIGHTS

- » Plug N' Play support for OpenEye IP cameras (PoE models only)
- » 1080p high definition recording
- » eSATA for external storage
- » High definition and VGA video output
- » 2-way audio (RADIUS to local recorder)
- » RADIUS multi-site remote video management software license included
- » ReportStar cloud-based health monitoring included
- » Free mobile apps for Mac, iPhone, iPad, and Android devices
- » Free DDNS for the life of the product
- » ONVIF™ Profile S compliant

E-SERIES POE NVR RECORDER

PRODUCT SPECIFICATIONS

	OE-ENVRPOE4	OE-ENVRPOE8	OE-ENVR16
Camera Channels	4 (3MP / 1080p) 50W PoE Max	8 (3MP / 1080p) 100W PoE Max	16 (3MP / 1080p) No PoE option
Max IPS per Channel	30IPS		
Recording Rate	120IPS	240IPS	240IPS
Total System Bit Rate	40Mbps		
Audio Outputs	Yes (Cameras with MIC supported) 1 RCA Out		
Video Outputs	HDMI & VGA		
Digital Relay Outputs	1		
Alarm Sensor Inputs	4		
Image Compression	H.264		
Recording Resolutions	800X600, 1024X768, 1280X1024, 1920X1080		
Video Signal Loss Detection	Yes		
Motion Detection	Yes (OpenEye cameras only)		
Remote Operation	Live View, Setup, PTZ, Firmware Update (RADIUS only)		
Remote Software	RADIUS, Web Viewer, Mac and Mobile apps		
PTZ Control	ONVIF		
Recording Mode	Schedules for Continuous, Motion, Sensor, Pre- and Post-Alarm, Instant, Quick Global Setup		
Playback Search	Multi-channel playback, Calendar and Timeline Search, Event and System Search, First and Last Search		
Backup	USB / Network		
Digital Signature Support	Support on AVI and JPG files		
Dynamic DNS	Free for the life of the product		
Operating System	Linux® embedded		
Storage Size	2TB, 4TB	2TB, 4TB, 6TB	2TB, 4TB, 6TB, 8TB, 12TB
External Storage Options	eSATA		
Power Supply	Input: 100 - 240vAC Output: 48vDC / 2.5A	Input: 100 - 240vAC Output: 48vDC / 4.2A	Input: 100 - 240vAC Output: 12vDC / 5A
Power Draw	55W		
Dimensions	L: 14.96" (380 mm) x W 14.17" (360 mm) x H 2.6" (66 mm)		
Warranty	3 Years / 1 Year Advanced Replacement		

E-SERIES NVR MODELS

OE-ENVRPOE4	4 Channel PoE NVR Recorder
OE-ENVRPOE8	8 Channel PoE NVR Recorder
OE-ENVR16	16 Channel NVR Recorder

SOFTWARE SOLUTIONS

RADIUS Multi-Site Software (Manages 100+ recorders simultaneously)
Mac Remote (Connect to one recorder at a time)
MDVR (iPhone, iPad, and Android devices)

E-SERIES POE NVR RECORDER

SYSTEM IMAGES

4/8/16CH FRONT

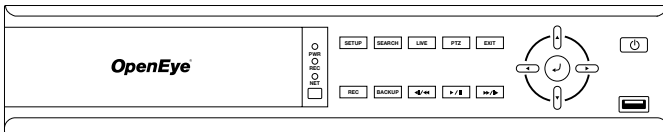

14.17" (360 mm)

4CH BACK

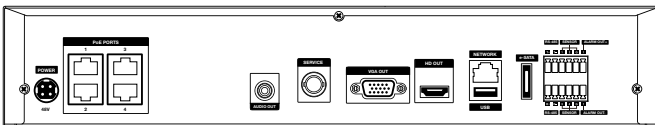

8CH BACK

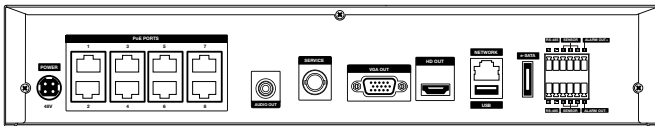

16CH BACK

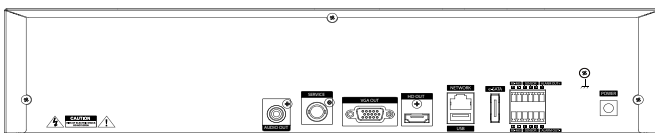

HIGH RESOLUTION

High definition 1080p video will make sure that you don't miss any detail while recording. With quality resolutions available for both live and recorded video, you can be sure that all the visual information of any scene is being captured.

COMPACT DESIGN

E-Series NVR recorders have the functionality of full-size NVR recorders from OpenEye, all housed in a compact chassis. With up to 8TB of storage available, the E-Series NVR recorder provides the detail and power you need in a manageable sized chassis.

EASY TO USE

OpenEye strives to create easy-to-use products, and all E-series recorders are designed to be intuitive to set up and operate. With Plug N' Play, your cameras will be showing live video quickly and easily, with no manual configuration needed. Aided by Quick Search and Quick Backup, you can save time when finding and saving recorded video.

STORAGE SPACE

4CH	2TB, 4TB
8CH	2TB, 4TB, 6TB
16CH	2TB, 4TB, 6TB, 8TB, 12TB

OpenEye

23221 E Knox Ave
Liberty Lake, WA 99019
1.888.542.1103



33040AE

©2015 OpenEye. All Rights Reserved. Information contained in this document is subject to change without prior notice. OpenEye does its best to provide accurate information but cannot be held responsible for typos or mistakes.